

# Disposable Doppler Probe for NEUROSURGERY

## Flexible and malleable, sterile disposable model

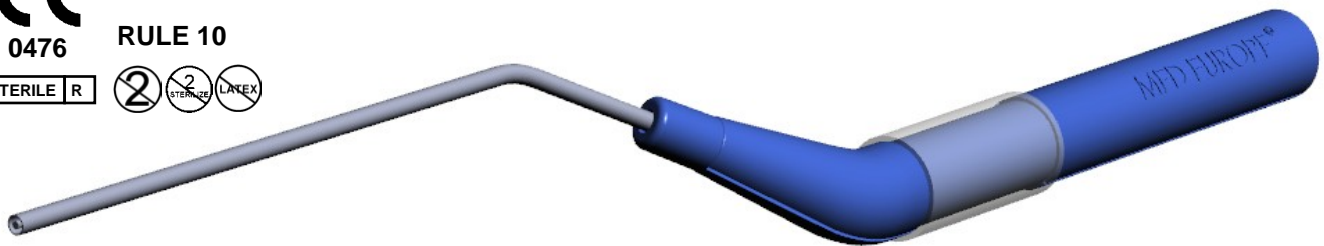

Flexible or malleable distal element  
Length of 120 mms.

Ergonomic and slip-resistant handle  
with medical grade silicone insert

### Characteristics

- Available in two frequencies of 10 or 20 MHz
- Flexible or malleable distal element
- Ergonomic and slip-resistant handle with medical grade silicone insert
- Total length of 250 mms.
- Distal element's length of 120 mms.
- Tip diameter: 0,8 - 1,2 - 2 mms.
- Disposable
- Handle made of styrolux
- Sterilised by Gamma Rays
- Double sterile packaging



Flexible probe, 20 MHz frequency



Malleable probe, 20 MHz frequency

### Compatible with HADECO Doppler models:

ES-100VX, ES-100V3, SD-45

The relative BDP amplifier series is necessary.

REF.	Frequency	Tip Diameter	Focal depth	Handle colour
MED NDP-10-2.0-F	10 MHz	2 mm	5 mm	WHITE
MED NDP-20-2.0-F	20 MHz	2 mm	3 mm	BLUE
MED NDP-20-1.2-F	20 MHz	1.2 mm	3 mm	BLUE
MED NDP-20-0.8-F	20 MHz	0.8 mm	3 mm	BLUE
MED NDP-20-2.0-M *	20 MHz	2 mm	3 mm	BLUE

\* Model with distal element in malleable steel

Manufactured by:



Via Gramsci, 9 - 40018 San Pietro in Casale (BO) - Italy  
Tel. +39 051.817902 +39 051.817850 Fax +39 051.817845  
www.simitalia.it www.medeurope.eu  
E-Mail: info@medeurope.eu

Distributed by:

